

ALL ABOUT LUNDY ISLAND

VER 170426T09_1



Steve Ransome and Diane Watling

WHERE IS LUNDY ISLAND?

- 12 miles from North Devon in Bristol channel
- Population – 28! Some holiday accommodation and camping
- “Lundy” may come from the old Norse word for "puffin island"

LUNDY
ISLAND

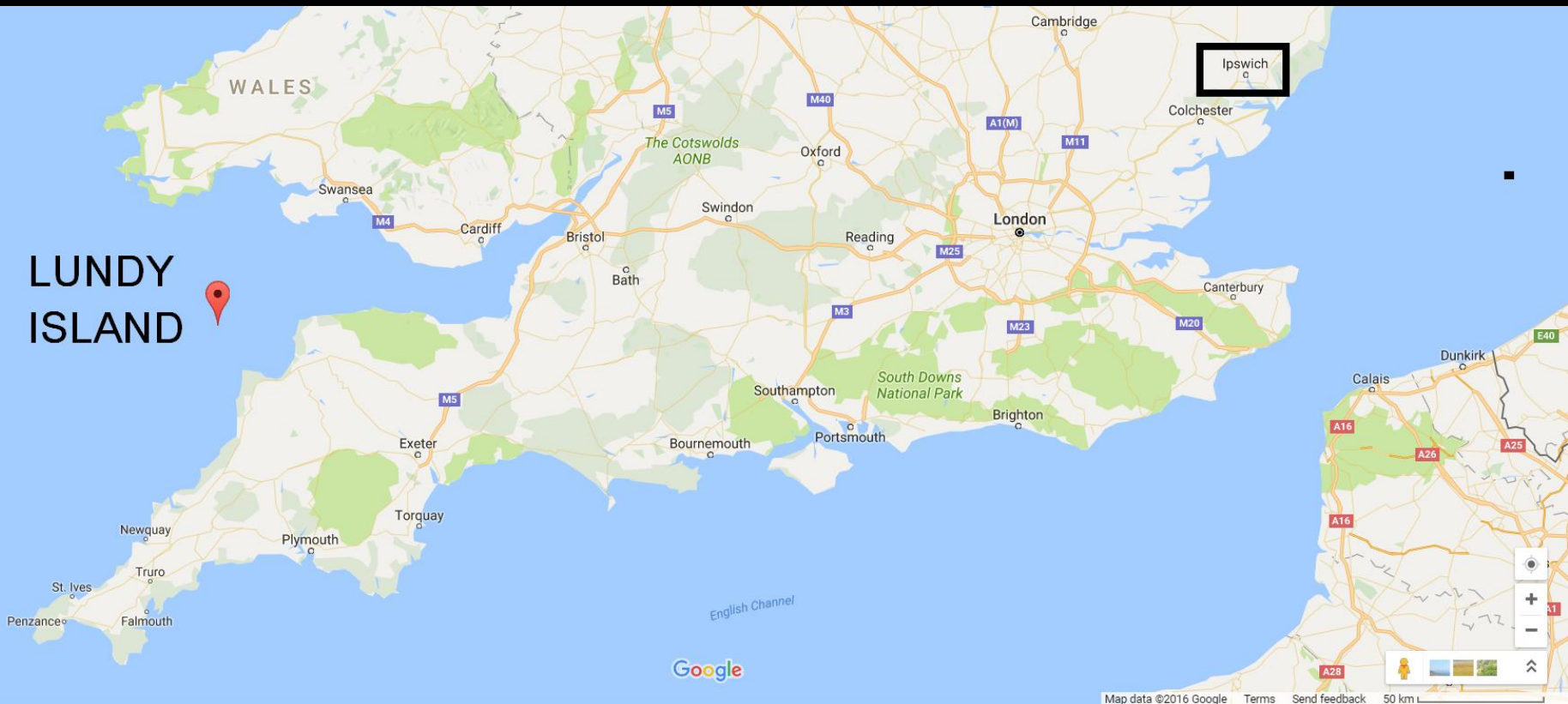

GETTING TO LUNDY

Boat alternates between Ilfracombe and Bideford

Need a night in Ilfracombe and another in Bideford

Trains to Barnstable

Buses from there



AERIAL VIEW OF LUNDY ISLAND WITH SEABED

“The Village”

Landing
stage



Image © 2009 TerraMetrics
Data SIO, NOAA, U.S. Navy, NGA, GEBCO
© 2009 InSitu Ltd & BlueSky
Image NASA

©2009 Google

AERIAL VIEW LUNDY ISLAND

3 * 1/2 MILE, 400FT HIGH



Photograph: Alison Mcdougall/Rex Features

SCALE VS. IPSWICH

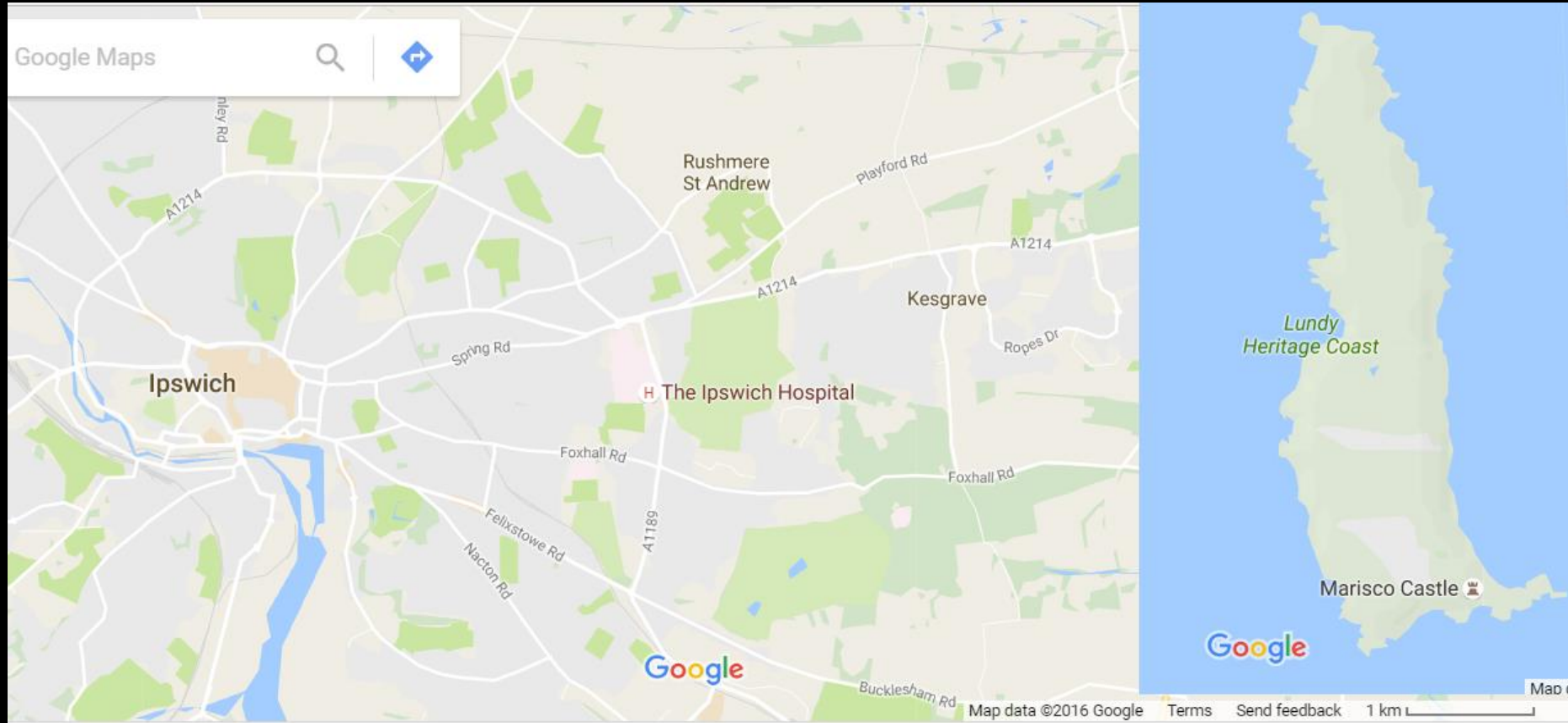

WHY GO TO LUNDY ?

- We'd never been
 - Unusual and a bit remote
 - Sometimes nice to go in the UK
 - Self cater in a cottage and buy dinner at the pub
 - Good wildlife, birdlife, scenery
-
- No TV, No wifi, No internet, No newspapers, No radio.
No mobile phone and No electricity at night

LUNDY MAP

3 * 1/2 MILE



No roads except landing bay to village

23 “Cottages”,

Three stone walls divide the island into quarters (to separate the land animals)

Long walks everywhere

Middle of the island is 400ft above sea level

Steep cliffs around much of island (no beaches)



A SHORT LUNDY HISTORY - 1

- Inhabited >3000 years – Bronze and Iron age settlements
- Vikings were there 900AD
- Listed in Domesday book 1086
- Owned by Marisco family for 100y
Claimed the throne through being descendance from an illegitimate Royal child.
They tried to kill Henry III and sided with pirates and England's enemies
William de Marisco was hung, drawn + quartered in 1242 for treason

A SHORT LUNDY HISTORY – 2

- For the next 600 years Lundy was used as pirate base, white slave trade and for smuggling
- Bought in 1843 by former slave owner William Heaven for £10,000
- Martin Harman bought it in 1925 for £25,000 and issued his own post and coinage.
- Then taken over by the National trust and Landmark trust for £150,000 for 60 year lease.

OUR TRIP TO LUNDY

VIEW OF ILFRACOMBE (1 NIGHT STAY BEFORE)



ILFRACOMBE – MEETING THE LOCALS



ILFRACOMBE HARBOUR WITH LUNDY SHIP MS OLDENBURG



MS OLDENBURG



LOADING THE LUGGAGE ONTO THE BOAT



LEAVING ILFRACOMBE HARBOUR



2 HOURS LATER ...

LUNDY ISLAND COMES INTO VIEW ...



EAST COAST LUNDY ISLAND



EAST COAST LUNDY ISLAND

No beaches,
very few ways down to the sea



DOCKING AT LUNDY'S LANDING STAGE LOW TIDE



LEAVING THE BOAT TO WALK UP TO THE VILLAGE

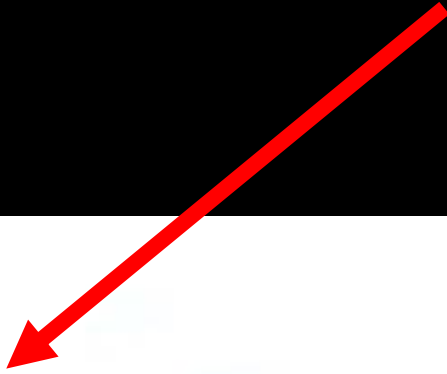

ENORMOUS ROCKS APPEAR AT LOW TIDE (32FT) ALMOST AS BIG AS WORLD'S LARGEST



THE LONG WALK



A JEEP TOOK OUR LUGGAGE AND THE LESS ABLE WALKERS



NEARING THE TOP WE CAN SEE THE VILLAGE



ALMOST THERE ! OUR HOUSE AT THE FRONT
ALSO THE CHURCH AND THE PUB



OUR ACCOMMODATION – GOVERNMENT HOUSE



ACCOMMODATION – THE LOUNGE



ACCOMMODATION – ONE OF THREE BEDROOMS



MARISCO TAVERN – LUNDY PUB OF THE YEAR EVERY YEAR



INSIDE MARISCO TAVERN



DECORATIONS ARE FROM SHIPWRECKS



DECORATIONS ARE FROM SHIPWRECKS



WHAT'S IN THE LUNDY SHOP? – VIDEOS ON THE WEB SHOW EVERYTHING AVAILABLE

 **You**Tube^{GB}

lundy island shop

Q



0:58 / 3:31

⚙️ □ []

Lundy Island Shop Walk-through.

 SpecialAction

 **Subscribe** 29

3,684 views

+ Add to ↗ Share ... More

👍 12 🗨️ 0

GETTING AROUND LUNDY – THERE ARE
NO CARS SO WALK EVERYWHERE UP TO 3 MILES



OLD LIGHT 1819 (WITH ACCOMMODATION)

Q) This lighthouse has a problem.
Can anyone guess what it is ?



OLD LIGHT 1819 (WITH ACCOMMODATION)

Q) This lighthouse has a problem.
Can anyone guess what it is ?

A) This light is too high!
It's often above the low lying fog !

**A fog signal was built later then two
more lighthouses**



CLIMBING UP OLD LIGHT



DECK CHAIRS TO
ADMIRE THE VIEW



VIEW NORTHWARDS FROM OLD LIGHT



THE VILLAGE FROM OLD LIGHT



ST. HELEN'S CHURCH (DEVON ON HORIZON)



INSIDE
ST. HELEN'S

(IT'S BEING
RENOVATED)



INSIDE ST. HELEN'S



WILDLIFE

SOAY SHEEP (FROM ST. KILDA) DRINKING IN THE SUNSHINE



RABBITS WERE
INTRODUCED
BY THE NORMANS
IN THE 12TH CENT.



MAKING FRIENDS WITH LUNDY PONY



PONY



HIGHLAND CATTLE – VERY DOCILE



HIGHLAND CATTLE – VERY DOCILE



JAPANESE SIKA DEER INTRODUCED TO LUNDY 1927



YOUNG SIKA DEER



ATLANTIC GREY SEAL (~100 AROUND LUNDY)



Photograph: Alan James/NPL/Rex Features

SEAL WAITING TO HAUL OUT AS
THE TIDE GOES DOWN



OTHER SEALS HAVE TO WAIT THEIR TURN

Apparently seals have to haul
out at low tide otherwise they
may tire and drown



ASLEEP IN THE SUN



BIRD WATCHING AT JENNY'S COVE



**Several day trippers (birders not twitchers)
were over as it was a Saturday**

PUFFINS
(NOT VERY
CLOSE !)

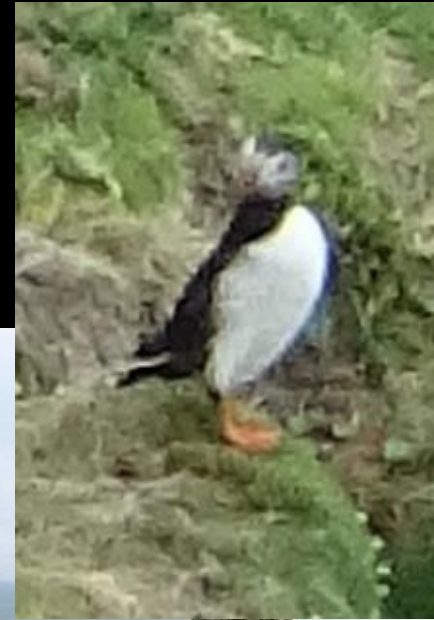

We've seen much closer in Scotland and Iceland

GUILLEMOTS



THE OLD BATTERY



THE OLD BATTERY

Built in 1863 as a fog signal station when it was realised Old Light was too high for it to be seen during heavy mists.



THE OLD BATTERY



**Two cottages to house workers and their families.
Up to 13 children lived here at one time**

FOG CANON AT THE BATTERY



VIEW FROM THE OLD BATTERY



BACK UP AGAIN



NORTH LIGHT



NORTH LIGHT



NORTH LIGHT AUTOMATIC



**SOLAR PANELS! MANY SEEM TO HAVE BEEN
DESTROYED BY STRONG WINDS AND REPLACED**



ANTONY GORMLEY STATUE

(FAMOUS BRITISH
SCULPTOR)

NO LONGER THERE

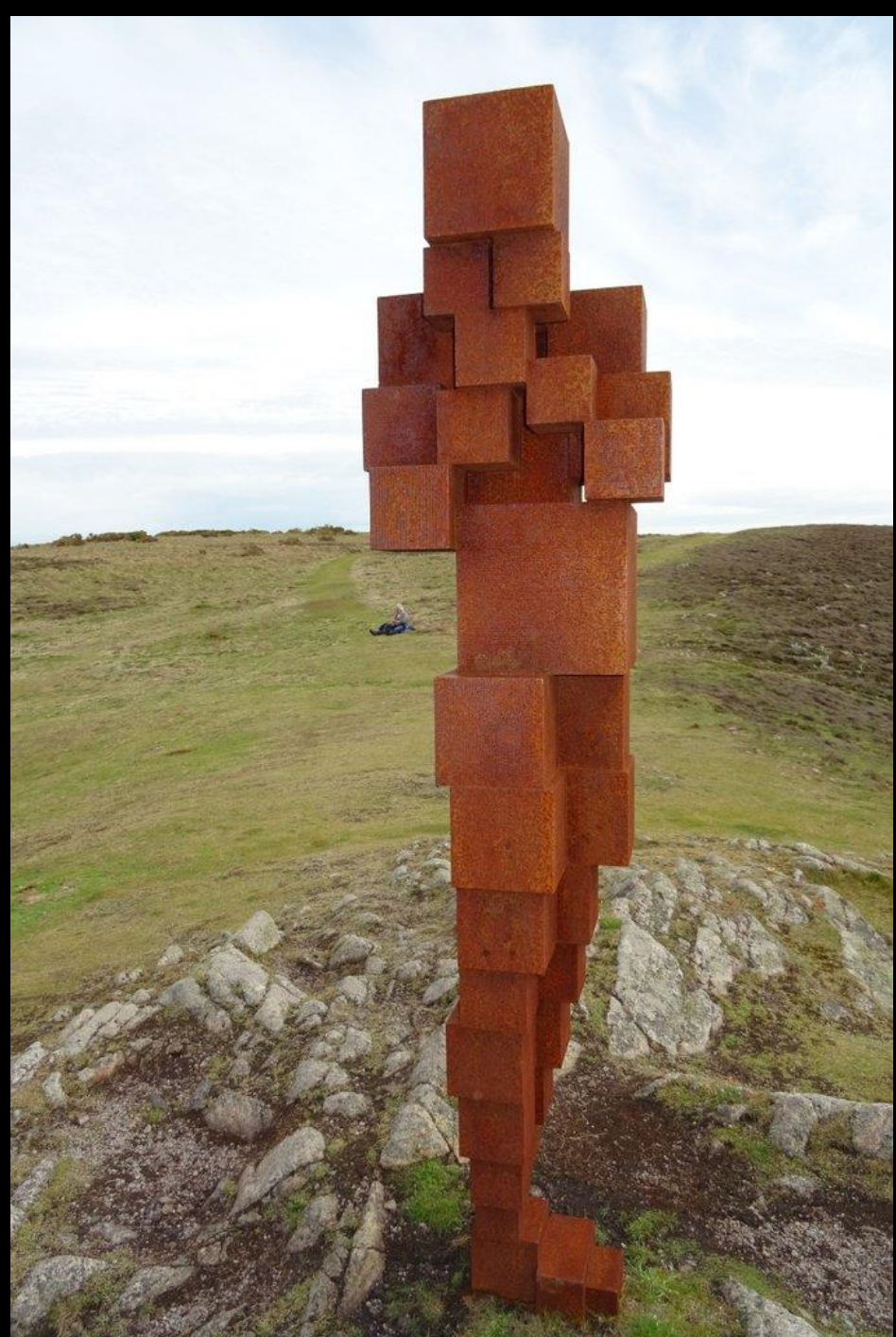

SMUGGLERS' CAVE

Convicts and
smuggled bounty
were kept here



“EARTHQUAKE” ZONE



STRANGE ROCK STRATA



YATCH



TREE PROTECTION FROM DEER



COCKEREL



FARMING, ALLOTMENT for local produce



FARMING FENCES TO KEEP THE DEER OUT



SOME OF THE ACCOMODATION



Camping

Lundy, Bristol Channel, Devon

The campsite on Lundy has room for up to 40 people and is in the centre of the village close to the tavern and shop.



Radio Room

Lundy, Bristol Channel, Devon

The Radio Room is cosy and self-contained, with an east-facing terrace. Lundy's beauty, community and way of life make it a world apart.



Old Light Cottage

Lundy, Bristol Channel, Devon

This was the lighthouse keepers' store, solidly built of granite and is the perfect place to explore Lundy's beauty, community and way of life.



Castle Keep North

Lundy, Bristol Channel, Devon

The three Castle Keep Cottages are built round a small courtyard inside the Keep and are a great place to stay to experience Lundy's beauty, community and way of life.



Old House South

Lundy, Bristol Channel, Devon

Old House, North and South, is the most handsome building on the island, in perhaps the best position, and made of the best-looking granite.



The Barn

Lundy, Bristol Channel, Devon

The Barn is a hostel for group bookings right at the heart of island life. One of the island's best views can be seen from the sleeping gallery.



Government House

Lundy, Bristol Channel, Devon

One of the most impressive houses on the island, it seems to have always been there, sheltered on three sides and looking down the Millcombe valley towards the sea.



Millcombe House

Lundy, Bristol Channel, Devon

A large classical villa built for the Heaven family which looks down a wooded valley and out to sea.

LUNDY CASTLE (1243(ACCOMMODATION



TIBBETS – WITHOUT MAINS ELECTRICITY!

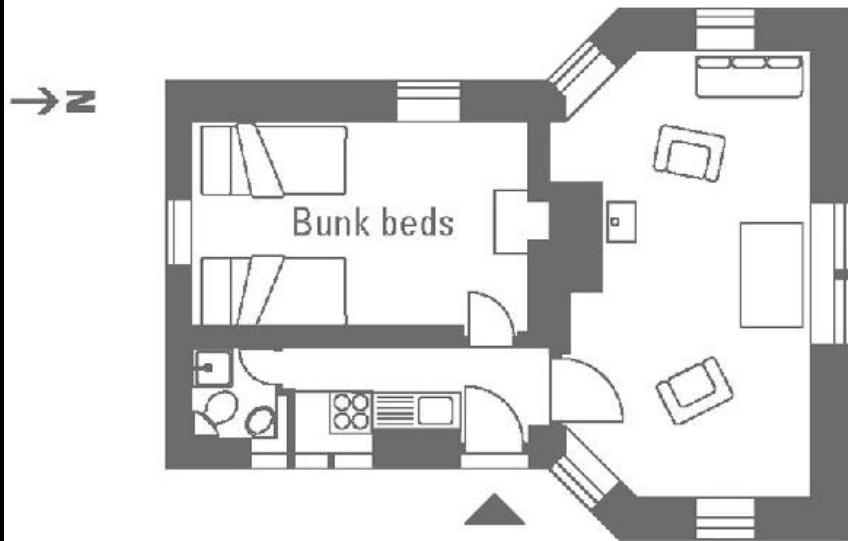

STONECROP FLOWERS



WEST COAST – SHOWING OLD LIGHT



WEST COAST – A YACHT AT ANCHOR



WEST COAST – WONDERFUL ROCK COLOURING



DIVING BOAT



VISITING EXPEDITION SHIP ON ITS WAY TO THE ARCTIC



ROCKS AT THE LANDING JETTY



AT LANDING JETTY



AT LANDING JETTY



FOG CAN BE VERY UNPREDICTABLE



FOG CAN BE VERY DENSE



OUR TRIP AROUND THE ISLAND



LOOKING TOWARDS WEST LUNDY – FOG!



THE FOG CLEARED AS WE DOCKED AGAIN



BACK TO THE
MAINLAND

**Thank you for
your attention !**



INDIA

Steve Ransome's next talk at Gressland 27th April **INDIA**



India



Our Journey



Astronomical observatory



Hindu Temples



Street Vendors



Transport



Muslim tomb



The Taj Mahal



Architecture



People we visited

SOURCES (DON'T SHOW THIS)

- <https://en.wikipedia.org/wiki/Lundy>
- <https://www.theguardian.com/environment/gallery/2009/sep/28/lundy-island-40#/?picture=353149549&index=0>
- Guillemot Stone Crop Old light St Helena's church
- <http://www.landmarktrust.org.uk/lundyisland/discovering-lundy/wildlife/above-the-waves/mammals/>
- <http://theislandreview.com/content/lundy-island>
- <http://www.lundy.org.uk/tour/>
- <http://www.landmarktrust.org.uk/lundyisland/discovering-lundy/history/>
- <http://www.worldwidelighthouses.com/Lighthouses/English-Lighthouses/Private-ly-Owned/Lundy-Old>
- <https://www.flickr.com/photos/brizzlebornandbred/8993590093>
- <http://www.fairyjo.info/News/2006/07/26/>

CONTENTS (UPDATE AND REARRANGE)

- Location
- History – Conquest, pirates
- Getting there
- Buildings and accommodation; power
- Geography – cliffs, aquifer?
- Animals
- Birds
- Plants
- Etc.